

TOWNSHIP II NORTH, RANGE 21 EAST, OF THE INDIAN MERIDIAN, OKLAHOMA
DEPENDENT RESURVEY AND SURVEY

Adjusted 1897 Right Bank Record Meanders in Sec. 3 (Arkansas River)

From the 1897 MC, sections 2 and 3 thence;
N.62°47'W. 8.17
N.73°34'W. 6.98
N.71°04'W. 1.99
1897 MC Secs. 3 and 34

Adjusted 1897 Right Bank Record Meanders in Sec. 3 (Canadian River)

From the 1897 MC, sections 3 and 10 thence;
N.45°37'E. 12.98
N.48°07'E. 13.98
N.72°08'E. 3.50
1897 MC Secs. 2 and 3

Adjusted 1897 Left Bank Record Meanders in Sec. 3 (Canadian River)

From the 1897 MC, sections 3 and 10 thence;
N.46°05'E. 22.98
N.50°05'E. 9.99
N.60°06'E. 14.99
1897 MC Secs. 2 and 3

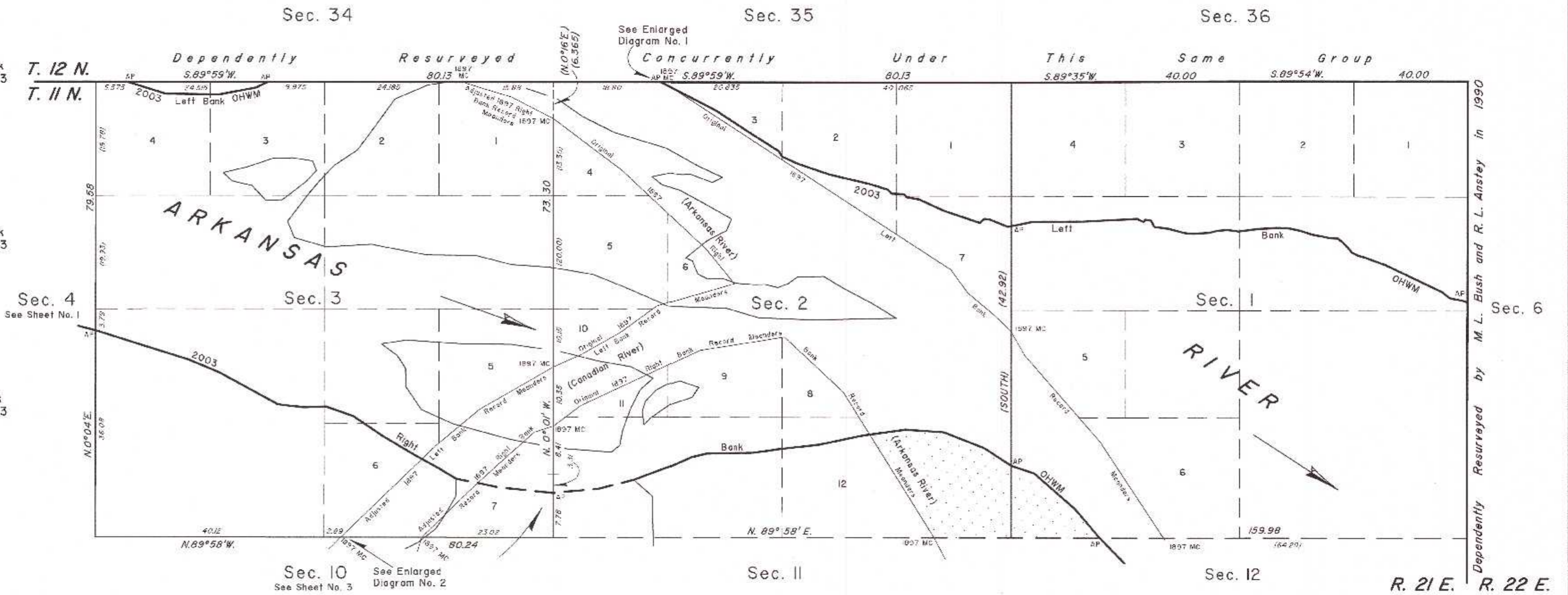

2003 Arkansas River in Section 1 Left Bank OHWM as Digitized

From AP, sections 1 and 6, at 2003 Left Bank OHWM, thence upstream in section 1;
N.5°06'W. 0.54
N.79°04'W. 2.78
N.5°36'W. 1.67
N.64°18'W. 10.94
N.70°27'W. 4.06
N.76°03'W. 1.01
N.63°09'W. 1.15
N.42°5'W. 2.58
N.53°42'W. 0.99
N.84°50'W. 1.43
N.79°35'W. 3.21
N.71°22'W. 2.25
N.80°01'W. 2.04
N.88°37'W. 2.05
S.86°49'W. 3.40
S.82°42'W. 2.84
S.73°45'W. 0.35
N.81°36'W. 2.05
S.85°11'W. 1.66
S.77°06'W. 1.81
S.87°2'W. 2.56
N.86°2'W. 1.41
N.75°39'W. 2.95
N.82°21'W. 2.97
N.27°31'W. 1.28
N.82°57'W. 1.01
S.37°29'W. 0.51
N.63°34'W. 1.28
S.87°04'W. 9.49
S.89°41'W. 8.74
S.78°08'W. 3.48
S.76°05'W. 0.42
AP sections 1 and 2 (Calculated Line)

2003 Arkansas River in Section 2 Left Bank OHWM as Digitized

From AP, sections 1 and 2 (calculated line), at 2003 Left Bank OHWM, thence upstream in section 2;
S.76°05'W. 0.53
N.67°47'W. 3.51
N.82°49'W. 0.90
S.48°44'W. 1.08
N.71°44'W. 6.60
N.65°24'W. 4.81
N.79°10'W. 2.27
N.43°01'W. 0.67
N.87°37'W. 2.11
N.46°11'W. 1.02
N.72°54'W. 3.39
N.77°00'W. 7.07
N.70°58'W. 5.76
N.66°25'W. 3.17
N.28°45'W. 1.02
N.57°49'W. 5.95
N.56°53'W. 7.38
N.62°56'W. 10.66
AP sections 2 and 35

2003 Arkansas River in Section 3 Left Bank OHWM as Digitized

From AP, sections 3 and 34, at 2003 Left Bank OHWM, thence upstream in section 3;
S.64°58'W. 2.31
S.79°19'W. 6.55
N.89°03'W. 9.46
N.72°46'W. 6.83
AP sections 3 and 34

2003 Arkansas River in Section 1 Right Bank OHWM as Digitized

From AP, sections 1 and 12 (projected line), at 2003 Right Bank OHWM, thence upstream in section 1;
N.40°44'W. 6.62
N.48°45'W. 9.47
N.71°36'W. 4.30
AP sections 1 and 2 (Calculated Line)

2003 Arkansas River in Section 2 Right Bank OHWM as Digitized

From AP, sections 1 and 2 (calculated line), at 2003 Right Bank OHWM, thence upstream in section 2;
N.56°48'W. 5.67
N.68°38'W. 7.57
N.86°17'W. 6.72
S.82°10'W. 7.62
S.77°51'W. 7.70
S.83°46'W. 6.72
S.82°02'W. 4.98
S.88°44'W. 8.14
S.76°56'W. 2.62
S.65°58'W. 4.05
S.69°33'W. 6.88
S.75°58'W. 6.54
S.84°44'W. 7.80
AP sections 2 and 3

2003 Arkansas River in Section 3 Right Bank OHWM as Digitized

From AP, sections 2 and 3, at 2003 Right Bank OHWM, thence upstream in section 3;
N.84°13'W. 9.34
N.78°42'W. 7.90
N.58°48'W. 3.79
N.61°31'W. 4.69
N.59°00'W. 6.54
N.56°03'W. 6.06
N.70°43'W. 4.97
S.88°44'W. 4.07
N.83°41'W. 4.40
N.6°32'W. 7.04
N.61°32'W. 4.69
N.67°19'W. 5.73
N.72°44'W. 16.62
N.75°30'W. 0.56
AP sections 3 and 4

2003 Arkansas Riverbed in Section 1
Claim Area ±404.77 Acres
1897 Arkansas Riverbed Claim Area ±11.76 Acres

1897 Arkansas Riverbed Claim Area

2003 Arkansas Riverbed in Section 2
Claim Area ±431.43 Acres (Includes Islands)
1897 Arkansas Riverbed Claim Area ±32.90 Acres

2003 Arkansas Riverbed in Section 3
Claim Area ±463.96 Acres (Includes Islands)

ENLARGED DIAGRAM No. 1 (Not to Scale)

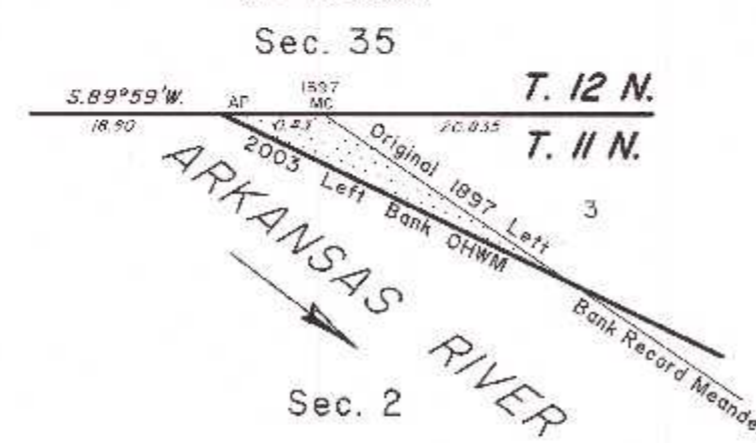

ENLARGED DIAGRAM No. 2 (Not to Scale)

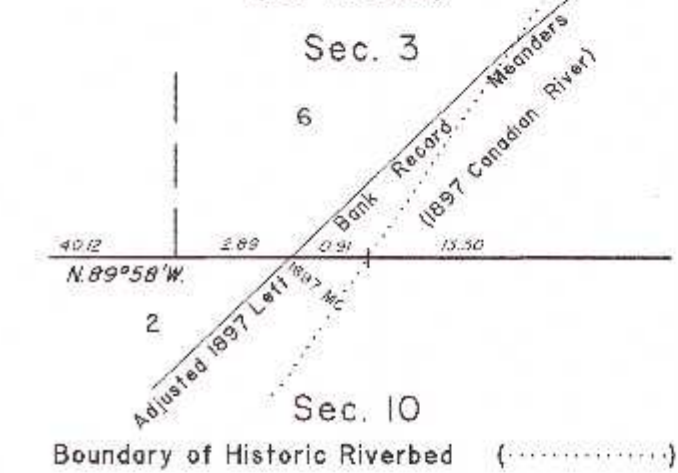

Reference should be made to sheet No. 1 for survey and disclaimer information.

UNITED STATES DEPARTMENT OF THE INTERIOR
BUREAU OF LAND MANAGEMENT

Sante Fe, New Mexico September 30, 2011

This plat is strictly conformable to the approved field notes, and the survey, having been correctly executed in accordance with the requirements of law and the regulations of this Bureau, is hereby accepted.

For the Director

Chief Cadastral Surveyor for New Mexico

