

TOWNSHIP 10 NORTH, RANGES 22 AND 23 EAST, OF THE INDIAN MERIDIAN, OKLAHOMA SUPPLEMENTAL PLAT

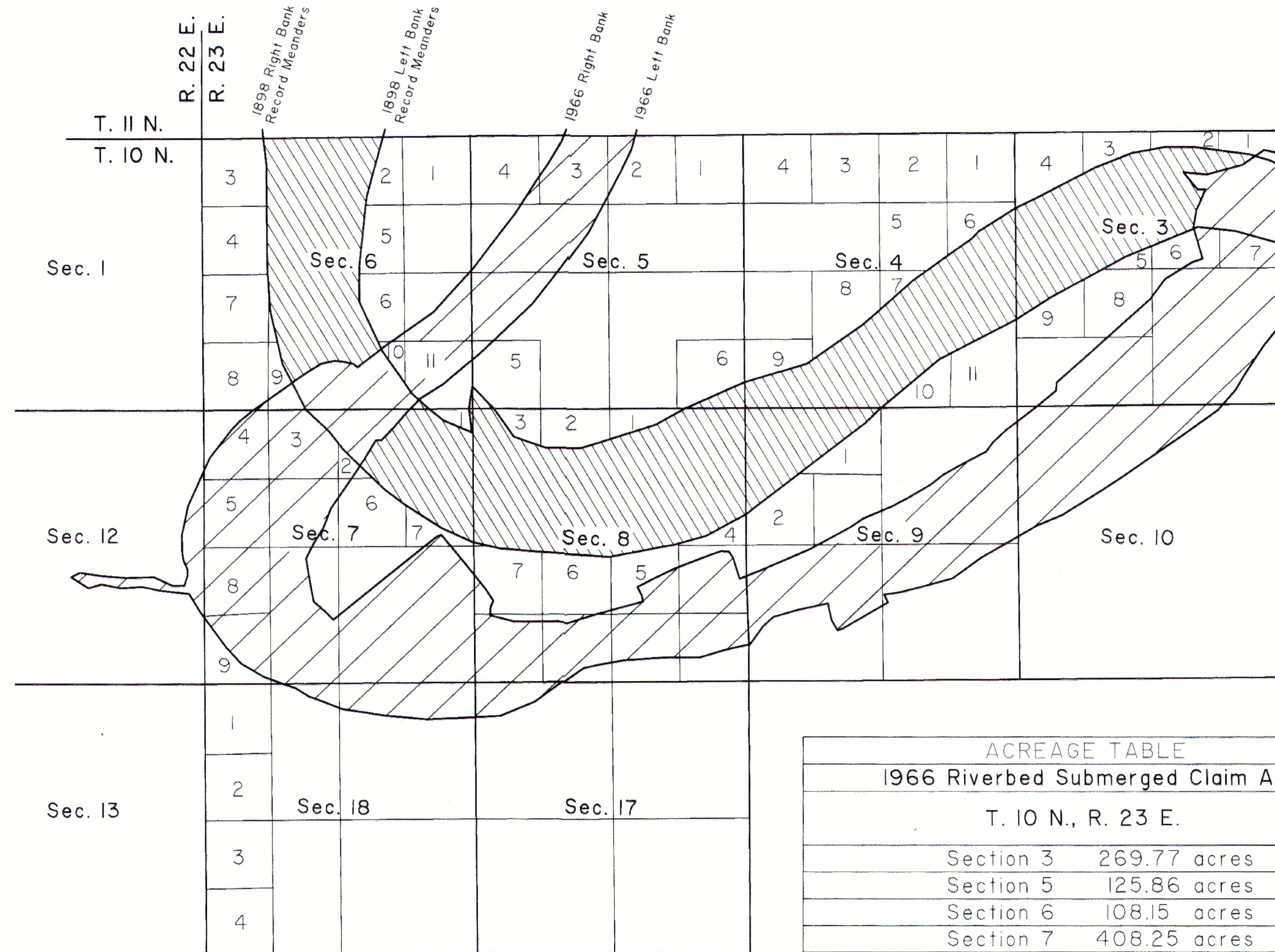

1966 Riverbed Submerged Claim Area



1898 Riverbed Claim Area

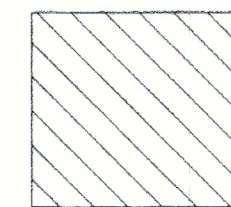

ACREAGE TABLE	
1966 Riverbed Submerged Claim Area	
T. 10 N., R. 23 E.	
Section 3	269.77 acres
Section 5	125.86 acres
Section 6	108.15 acres
Section 7	408.25 acres
Section 8	151.52 acres
Section 9	199.90 acres
Section 10	122.59 acres
Section 17	17.69 acres
Section 18	56.47 acres
TOTAL	1,460.20 acres
T. 10 N., R. 22 E.	
Section 12	45.76 acres
Overlap of the 1898 & 1966 Riverbed Claim Areas	
T. 10 N., R. 23 E.	
Section 3	54.77 acres
Section 6	45.76 acres
Section 7	20.60 acres
TOTAL	121.13 acres

This supplemental plat, showing Tribal claims, is based upon the plats approved November 1, 1898, and by examination of the best available evidence of river movements including historic aerial photography and maps. This evidence indicates the river moved southerly by accretive and erosive processes until 1966 after which the reservoir behind Kerr dam covered both the upland and the riverbed claim areas in an avulsive action.

UNITED STATES DEPARTMENT OF THE INTERIOR
BUREAU OF LAND MANAGEMENT

Santa Fe, New Mexico July 30, 2019

This supplemental plat, showing Tribal claims, is based upon the official records, and subsequent survey and mapping data, and having been correctly executed in accordance with the requirements of law, and the regulations of this Bureau, is hereby accepted.

For the Director

Christopher P. McDonald

Christopher P. McDonald
Acting Chief Cadastral Surveyor for New Mexico

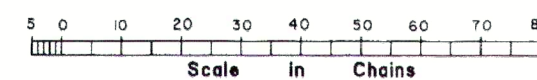

TOWNSHIP 10 NORTH, RANGES 22 AND 23 EAST, OF THE INDIAN MERIDIAN, OKLAHOMA
 SUPPLEMENTAL PLAT

1966 LEFT BANK of the ARKANSAS RIVER

From the cor. of secs. 4, 5, 32, and 33, Tps. 10 and 11 N., R. 23 E., S. 89° 57' W., 33.09 chs. dist., to the Point of Beginning (POB), between secs. 5 and 32. Thence downstream on the 1966 left bank in sec. 5.

S.15° 54' W.	4.07
S.31° 48' W.	8.21
S.28° 45' W.	20.21
S.37° 26' W.	16.85
S.38° 32' W.	10.06
S.46° 57' W.	21.06

Intersect the line bet. secs. 5 and 6, thence downstream on the 1966 left bank in sec. 6.

S.46° 57' W.	1.06
S.49° 57' W.	6.58
S.50° 43' W.	8.77
S.57° 26' W.	4.34

Intersect the 1898 Left Bank record meanders

S.57° 26' W.	3.81
S.46° 54' W.	1.37
S.44° 35' W.	0.19

Intersect the line bet. secs. 6 and 7, thence downstream on the 1966 left bank in sec. 7.

S.44° 35' W.	4.05
S.41° 42' W.	6.47
S.44° 28' W.	4.75
S.89° 22' W.	1.67
S.32° 10' W.	4.21

Intersect the 1898 Right Bank record meanders

S.32° 10' W.	2.13
S.34° 20' W.	3.33
S.35° 14' W.	14.37
S.22° 28' W.	6.26
S.30° 59' W.	5.50
S.27° 59' W.	5.09

S.09° 37' E.	12.86
S.48° 18' E.	5.21
S.43° 16' E.	2.79
N.51° 40' E.	39.47
N.70° 49' E.	1.51
S.39° 03' E.	7.86
S.38° 30' E.	13.04
S.32° 08' E.	0.75

Intersect the line bet. secs. 7 and 8, thence downstream on the 1966 left bank in sec. 8.

S.32° 08' E.	3.29
S.22° 57' W.	2.09
S.00° 58' W.	2.38
S.74° 51' E.	7.15
S.89° 27' E.	9.43
N.89° 41' E.	3.64
S.80° 03' E.	2.56
N.72° 46' E.	9.57
N.75° 40' E.	13.98
N.10° 44' W.	2.03
N.26° 44' W.	2.70
N.63° 20' E.	5.80
N.65° 07' E.	6.55
N.69° 38' E.	11.93
N.71° 31' E.	2.95
S.86° 58' E.	2.28
S.31° 40' E.	2.24
S.16° 40' E.	6.53
N.69° 10' E.	5.16

Intersect the line bet. secs. 8 and 9, thence downstream on the 1966 left bank in sec. 9.

N.69° 10' E.	1.97
N.67° 08' E.	15.42
N.61° 56' E.	14.04
N.56° 50' E.	4.52
N.68° 03' E.	9.15
N.62° 14' E.	5.65
N.60° 31' E.	7.77
N.53° 48' E.	4.59
N.60° 36' E.	5.42
N.62° 55' E.	9.12

N.36° 56' E.	3.44
N.48° 04' E.	5.36
N.53° 51' E.	6.73

Intersect the line bet. secs. 9 and 10, thence downstream on the 1966 left bank in sec. 10.

N.53° 51' E.	1.67
N.51° 24' E.	6.71

Intersect the line bet. secs. 3 and 10, thence downstream on the 1966 left bank in sec. 3.

N.51° 24' E.	3.85
N.03° 39' E.	2.41
N.48° 59' E.	16.71
N.48° 40' E.	10.12
N.49° 08' E.	10.47
N.36° 18' E.	7.34
N.58° 14' E.	9.47
N.72° 09' E.	3.47
N.15° 48' W.	9.60

Intersect the 1898 Right Bank record meanders

N.15° 48' W.	0.16
N.10° 37' E.	5.25
N.24° 23' E.	3.83
N.22° 41' E.	2.77
S.86° 46' W.	2.22
N.39° 26' W.	6.80
S.83° 31' E.	7.06
N.75° 21' E.	10.93
N.56° 21' E.	6.01

Intersect the 1898 Left Bank record meanders

N.56° 21' E.	1.91
S.89° 58' E.	7.68

Intersect the line bet. secs. 2 and 3, thence along the sec. line, bet. secs. 2 and 3.

S.00° 09' E.	47.74
--------------	-------

Intersect the 1966 right bank of the Arkansas River

Reference should be made to Sheet No. 1 for survey information.

UNITED STATES DEPARTMENT OF THE INTERIOR
 BUREAU OF LAND MANAGEMENT

Santa Fe, New Mexico July 30, 2019

This supplemental plat, showing Tribal claims, is based upon the official records, and subsequent survey and mapping data, and having been correctly executed in accordance with the requirements of law and the regulations of this Bureau, is hereby accepted.

For the Director

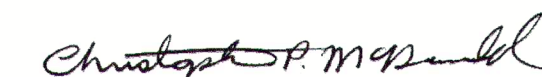

Christopher P. McDonald
 Acting Chief Cadastral Surveyor for New Mexico

TOWNSHIP 10 NORTH, RANGES 22 AND 23 EAST, OF THE INDIAN MERIDIAN, OKLAHOMA
SUPPLEMENTAL PLAT

1966 RIGHT BANK of the ARKANSAS RIVER

From the line bet. secs. 2 and 3, thence upstream on the 1966 right bank of the Arkansas River	
S.44°29'W.	1.63
S.39°41'W.	9.83
S.34°19'W.	10.40
S.30°34'W.	5.18
S.41°48'W.	5.49
Intersect the line bet. secs. 3 and 10, thence upstream on the 1966 right bank in sec. 10	
S.41°48'W.	2.50
S.55°26'W.	15.23
S.56°21'W.	18.90
S.57°22'W.	7.75
S.58°22'W.	13.90
S.68°38'W.	8.20
S.60°41'W.	4.91
Intersect the line bet. secs. 9 and 10, thence upstream on the 1966 right bank in sec. 9	
S.60°41'W.	13.85
S.54°34'W.	10.90
S.75°36'W.	9.77
S.75°58'W.	5.94
S.81°54'W.	5.34
S.27°12'E.	2.65
S.60°22'W.	15.30
S.70°04'W.	1.97
N.28°28'W.	3.55
N.12°51'W.	5.15
S.77°57'W.	9.42
S.74°18'W.	7.23
S.47°47'W.	4.09
S.37°38'W.	5.01

Intersect the line bet. secs. 8 and 9, thence upstream on the 1966 right bank in sec. 8	
S.37°38'W.	1.74
S.77°34'W.	8.00
S.74°00'W.	7.42
N.89°42'W.	9.17
S.87°04'W.	5.19
S.86°51'W.	7.96
S.80°56'W.	7.66
S.77°43'W.	5.00
S.54°56'W.	5.53
Intersect the line bet. secs. 8 and 17, thence upstream on the 1966 right bank in sec. 17	
S.54°56'W.	12.03
S.67°31'W.	11.05
S.87°25'W.	4.45
Intersect the line bet. secs. 17 and 18, thence upstream on the 1966 right bank in sec. 18	
S.87°25'W.	7.51
S.88°07'W.	9.82
N.84°12'W.	12.59
N.81°00'W.	12.80
N.68°41'W.	10.72
N.57°40'W.	4.60
N.69°24'W.	7.30
Intersect the line bet. secs. 7 and 18, thence upstream on the 1966 right bank in sec. 7	
N.69°24'W.	2.90
N.58°47'W.	7.12
N.42°16'W.	6.72
N.35°58'W.	4.85
Intersect the Range Line, bet. secs. 7 and 12, Tp. 10 N., Rs. 22 and 23 E.,	

From the Range Line, bet. secs. 7 and 12, Tp. 10 N., Rs. 22 and 23 E., thence upstream along the 1966 right bank in sec. 12, T. 10 N., R. 22 E.	
N.35°58'W.	8.08
N.31°27'W.	6.21
N.82°45'W.	8.78
N.77°59'W.	5.42
S.87°03'W.	6.21
N.79°06'W.	5.99
S.74°47'W.	4.03
N.57°23'W.	6.06
N.62°58'E.	2.93
S.80°58'E.	6.94
S.85°38'E.	6.91
N.89°14'E.	8.38
S.64°57'E.	6.02
S.89°31'E.	3.49
N.19°12'E.	3.25
N.02°42'W.	1.77
N.23°38'W.	2.97
N.08°28'W.	2.19
N.00°55'W.	5.42
N.12°59'E.	8.78
N.24°51'E.	15.53
N.38°59'E.	2.53
Intersect the Range Line, bet. secs. 7 and 12, Tp. 10 N., Rs. 22 and 23 E.,	

From the Range Line, bet. secs. 7 and 12, Tp. 10 N., Rs. 22 and 23 E., thence upstream along the 1966 right bank in sec. 7, T. 10 N., R. 23 E.	
N.38°59'E.	8.28
N.45°22'E.	3.60
N.51°08'E.	3.70
N.54°58'E.	1.90
Intersect the line bet. secs. 6 and 7, thence upstream on the 1966 right bank in sec. 6	
N.54°58'E.	1.36
N.55°09'E.	13.10
N.55°38'E.	1.71
Intersect the 1898 Right Bank record meanders	
N.55°38'E.	2.82
N.58°35'E.	4.76
N.78°30'E.	3.96
S.85°22'E.	2.68
S.76°37'E.	3.26
S.49°16'E.	1.52
N.52°30'E.	8.97
N.55°11'E.	2.52
Intersect the 1898 Left Bank record meanders	
N.55°11'E.	16.52
N.42°40'E.	17.77
N.38°03'E.	2.58
Intersect the line bet. secs. 5 and 6, thence upstream on the 1966 right bank in sec. 5	
N.38°03'E.	17.23
N.33°01'E.	11.82
N.35°51'E.	6.10
N.40°39'E.	8.21
N.21°09'E.	1.62
Intersect the Township Line bet. secs. 5 and 32, thence along the Township Line	
N.89°57'E.	21.00
To the POB	

Reference should be made to Sheet No. 1 for survey information.

UNITED STATES DEPARTMENT OF THE INTERIOR
BUREAU OF LAND MANAGEMENT

Santa Fe, New Mexico July 30, 2019

This supplemental plat, showing Tribal claims, is based upon the official records, and subsequent survey and mapping data, and having been correctly executed in accordance with the requirements of law and the regulations of this Bureau, is hereby accepted.

For the Director

Christopher P. McDonald

Christopher P. McDonald
Acting Chief Cadastral Surveyor for New Mexico

T. 10 N., Rs. 22 & 23 E., IM, OK